

MISHAWAKA AVENUE

**PARKING REQUIREMENTS**

TEN (10) PARKING SPACES PLUS ONE (1) PARKING SPACE PER EVERY 300 SQ. FT. OF GROSS FLOOR AREA OVER 2,000 SQ. FT.

7,505 SQ. FT. EXISTING BUILDING  
3,000 SQ. FT. ADDITION  
10,505 SQ. FT.  
-2,000  
8,505 DIVIDED BY 300 = 28.35

28 + 10 = 38 TOTAL REQUIRED

44 PROVIDED

**SITE CONCERNS**

1. BUILDING SETBACK REQUIREMENT.
2. PARKING REQUIREMENTS.
3. ADDITIONAL PROPERTY.

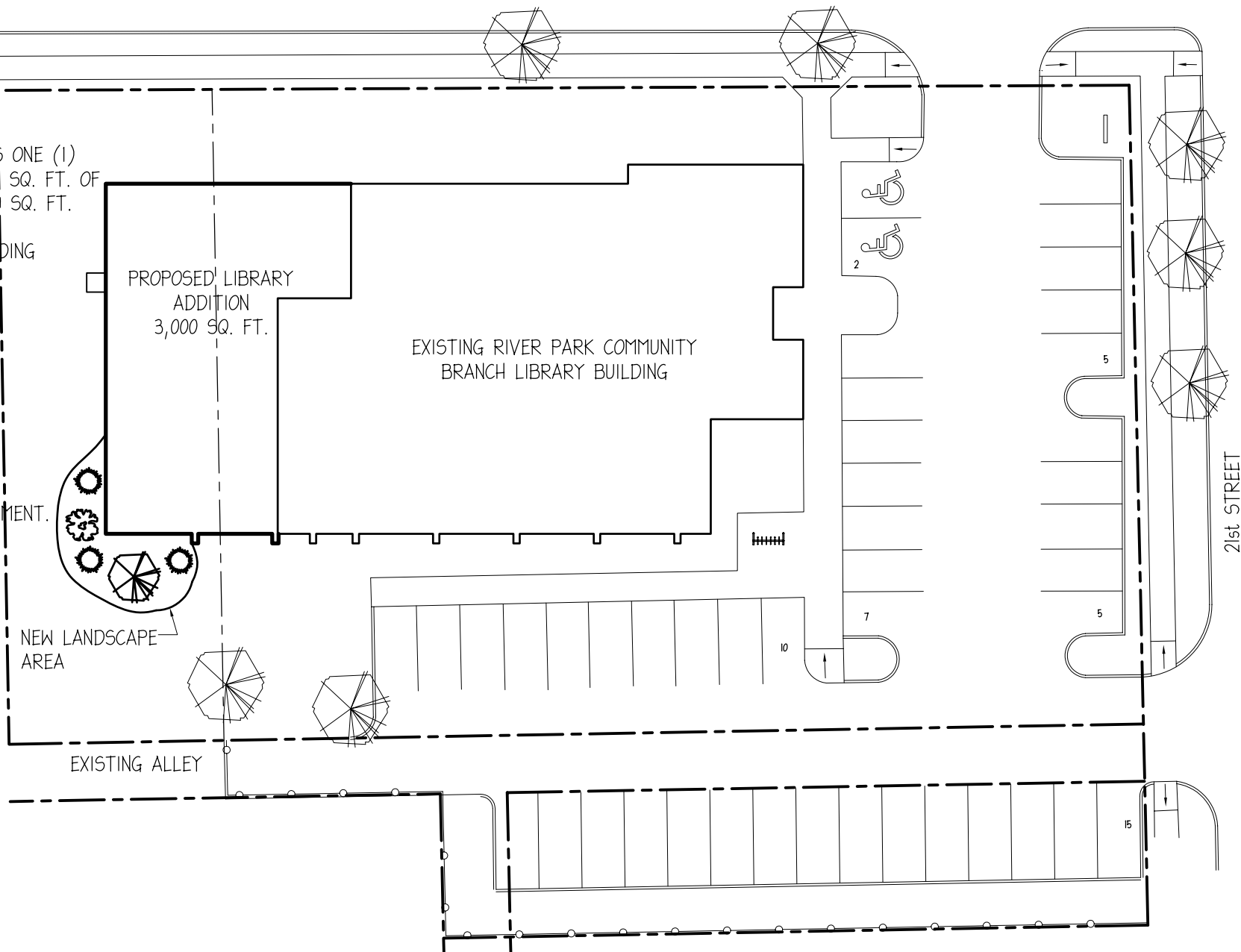

DESIGN DEVELOPMENT  
MARCH 26, 2007

**SITE PLAN**

SCALE: 1" = 30'-0"

